

ARRAY TYPE	No. of FRAMES	PANELS / FRAME	No. of PANELS	WATTS / PANEL	TOTAL OUTPUT
TYPE 1	400	12	4,800	180	784,000
TYPE 2	240	20	4,800	180	784,000
TOTAL			9,600		1,728,000 WATTS (1.73 MW)

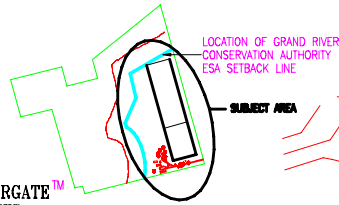

GENERAL NOTES

- Information regarding any existing services and/or utilities shown in this set of plans furnished as the best available information. The contractor shall interpret this information as he sees fit with the understanding that the owner disclaims all responsibility for its accuracy and/or sufficiency.
- All dimensions shall be checked and verified in the field by the contractor prior to any construction and he shall report any discrepancies immediately to the Engineer.
- The notes on this sheet apply to all works under this contract unless otherwise noted on detail drawings.
- Relocation of existing services and/or utilities shall be as shown on drawings or as directed by the Engineer at the expense of the Owner.
- This plan should be read in conjunction with detailed structural and electrical drawings supplied by others.
- Substitution of any materials will not be permitted without the written consent from the Owner.
- Structural Engineering Design by others.
- Electrical Engineering Design by others.
- Entire Solar Farm area to be planted with Red Clover before installation.
- Site to be restored and replanted as necessary following installation.

SATCON POWER SYSTEMS - POWERGATE™
500 Kw PHOTOVOLTAIC INVERTER
N.T.S. - DESIGN BY OTHERS

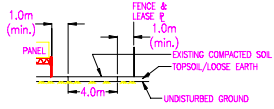

ARRAY ACCESS PATH
(TO BE REMOVED WHEN ARRAYS ARE DISMANTLED)

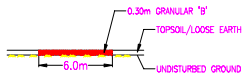

ACCESS DRIVEWAY
(TO BE REMOVED WHEN ARRAYS ARE DISMANTLED)

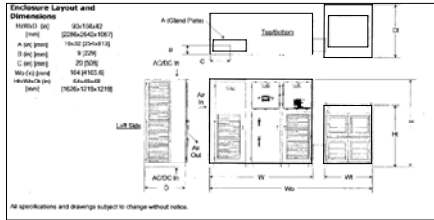

FRAME DESIGNS PROVIDED BY DECLOET GREENHOUSE MANUFACTURING LTD.

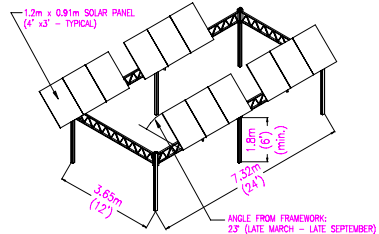

FRAME TYPE 1 - TRACKING
N.T.S. - DESIGN BY OTHERS

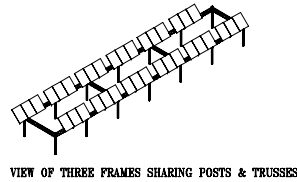

VIEW OF THREE FRAMES SHARING POSTS & TRUSSES

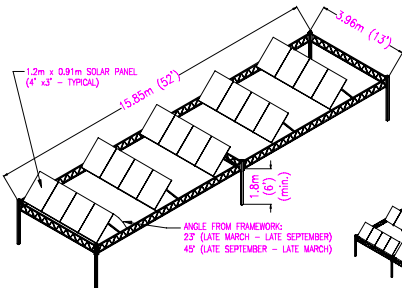

FRAME TYPE 2 - FIXED
N.T.S. - DESIGN BY OTHERS

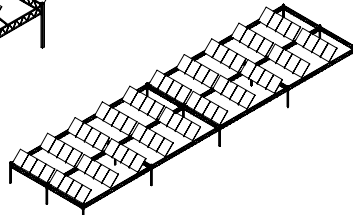

VIEW OF FOUR FRAMES SHARING POSTS & TRUSSES

STRUCTURAL ENGINEERING DESIGN BY OTHERS

PART OF LOTS 31 AND 32,
CONCESSION 12
TOWNSHIP OF NORTH DUMFRIES
REGIONAL MUNICIPALITY OF WATERLOO
(FORMERLY TOWNSHIP OF NORTH DUMFRIES, COUNTY OF WATERLOO)
1236 KINGS ROAD
NORTH DUMFRIES, ONTARIO

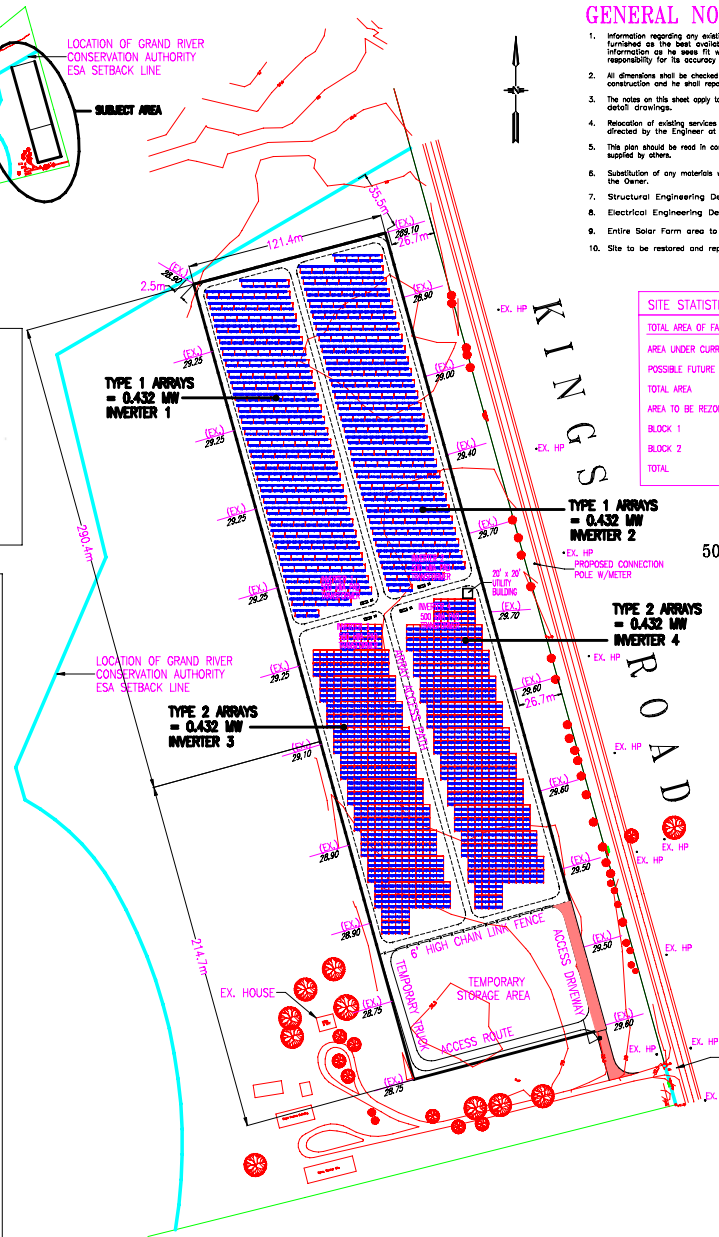

SITE STATISTICS	
TOTAL AREA OF FARM	122 Acres (49.4 Ha)
AREA UNDER CURRENT SITE PLAN APPLICATION	12.8 Acres (5.16 Ha)
POSSIBLE FUTURE EXPANSION	2.3 Acres (0.95 Ha)
TOTAL AREA	15.10 Acres (6.11 Ha)
AREA TO BE REZONED TO ALLOW SOLAR ELECTRICAL GENERATION	
BLOCK 1	12.8 Acres (5.16 Ha)
BLOCK 2	2.3 Acres (0.95 Ha)
TOTAL	15.1 Acres (6.11 Ha)

500 kVA PAD MOUNTED, LOW PROFILE TRANSFORMER
N.T.S. - DESIGN BY OTHERS

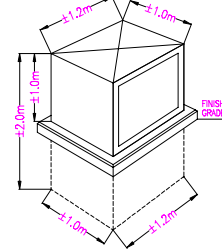

TYPE 2 ARRAYS
= 0.432 MW
INVERTER 4

TYPE 1 ARRAYS
= 0.432 MW
INVERTER 2

TYPE 1 ARRAYS
= 0.432 MW
INVERTER 1

TYPE 2 ARRAYS
= 0.432 MW
INVERTER 3

EX. HOUSE

TEMPORARY STORAGE AREA

EX. ENTRANCE

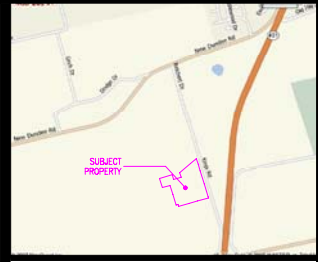

KEY PLAN

- #### LEGEND
- EX. HP - EX. HYDRO POLE
 - 1.8m GALVANIZED CHAIN LINK SECURITY FENCE
 - (E) - PROPOSED GRADE
 - (E) - EXISTING GRADE
 - PROPOSED INVERTER
 - EXISTING CONTOUR LINE
 - - EX. CONIFEROUS TREE
 - - EX. DECIDUOUS TREE
 - ARRAY ACCESS PATH (SEE DETAIL)
 - ACCESS DRIVEWAY (SEE DETAIL)
 - PROPOSED 500 KVA, LOW PROFILE, PAD MOUNTED TRANSFORMER

No.	Date	Revisions

Design	N.H.	Checked	SW	Print Dates
C.A.D.	N.H.	Checked	SW	DWG Dates

Scale: 1:1500 July 14, 2008

Field Notes:

Bell	Hydro
Gas	Cable
Stamp	

Consultants: **van der Woerd & Associates Ltd.**
Consulting Engineers
8800 Milliken Rd., Suite 100, Burlington, Ontario L7R 6W5
Phone: (905) 288-1088 Fax: (905) 288-9219

Municipality: **NORTH DUMFRIES**
REGIONAL MUNICIPALITY OF WATERLOO

Title: **TIM & ELIZABETH BARRIE ASPARAGUS FARM**
PROPOSED SOLAR FARM

Municipal Dwg. No.	Regional Dwg. No.
Control No.	Dwg. No.

07126 Sheet 1 of 1

